

Audley Flete House

Apartment 4
One bedroom, ground floor apartment

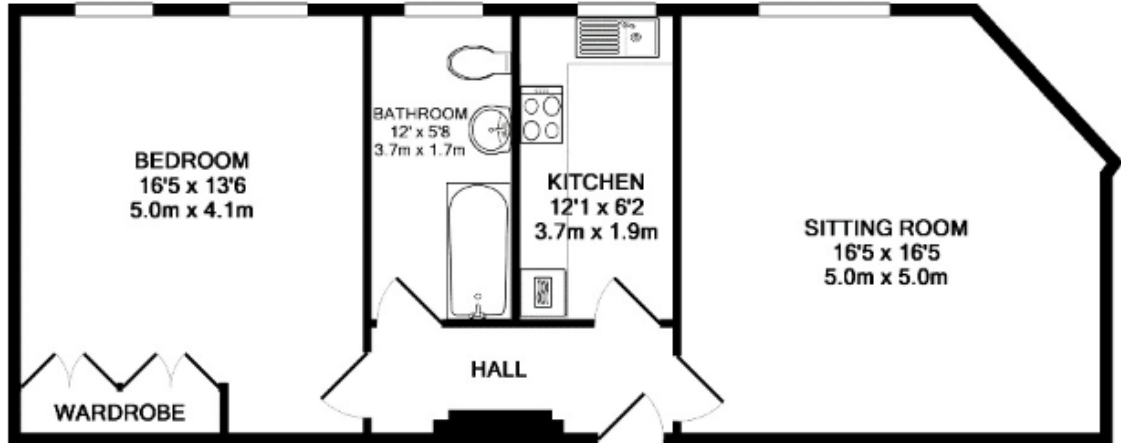

Internal Measurements

Metric (m)

Imperial (ft)

Kitchen	3.7 x 1.9	12'1" x 6'2"
Living room (sitting room)	5.00 x 5.00	16'5" x 16'5"
Bedroom 1	5.00 x 4.10	16'5" x 13'6"
Total approximate area	62.0	667"

Audley Flete House
Ivybridge, Devon PL21 9NZ
01752 830549
www.audleyvillages.co.uk

Maximum measurements shown. These pages are intended for marketing purposes only.
Designs vary according to plot and all details should be checked with the General Manager.

Audley Flete House

Apartment 4
One bedroom, ground floor apartment



One bedroom ground floor apartment

An elegant and spacious one bedroom first floor apartment located in the Mildmay Wing. Set within the Grade I Listed magnificent Flete House with twelve acres of manicured gardens.

Property specifications:

- Modern kitchen with integrated appliances
- Separate living room with countryside views
- Spacious double bedroom with fitted wardrobes
- Bathroom featuring white bath suite

Guide Price £140,000 (other fees apply)

Monthly management fee £1,130

Viewing by appointment with the General Manager.

Audley Flete House
Ivybridge, Devon PL21 9NZ
01752 830549
www.audleyvillages.co.uk