

5 Beech Court



5 Beech Court

A very well presented one bedroom apartment located in Beech Court. The apartment comprises of a large open plan lounge-diner with a Juliet balcony. Fully fitted kitchen with American style integrated fridge/freezer, oven, microwave, washing machine and dishwasher. The bedroom also benefits from a Juliet balcony and fitted wardrobes. Parking nearby.

Property specification

- Open plan lounge-diner-kitchen with integrated appliances as above.
- Double bedroom with fitted wardrobes and Juliet balcony
- Entrance hall with two storage cupboards and airing cupboard.
- Wet/shower room with WC. non-slip flooring
- Lift outside with access to guest suite.
- Parking nearby
- uPVC double glazing and central heating

£299,950 (other fees apply)

Monthly management fee: £1207.63

Annual ground rent: £200

Council Tax: C

A deferred management charge applies to this property, please ask the sales team for more information.

Viewing by appointment with the sales office.

01892 457 002

willicombesales@audleyvillages.co.uk



5 Beech Court

Internal Measurements	Metric (m)	Imperial (ft)
Lounge/Diner	4.6 x 4.2	15'1" x 13'9"
Kitchen	3.6 x 2.7	11'10" x 8'10"
Bedroom	4.4 x 3.4	14'5" x 11.2"
Hall	2.7 x 1.9	18.10" x 6.3"
Total Sq. Ft: 653		

Built in wardrobes in bedrooms have not been included in the overall dimensions. Maximum measurements shown.

Address: FLAT 5, BEECH COURT, WILLICOMBE PARK, ROYAL TUNB...
RRN: 0630-6529-6009-0518-1292

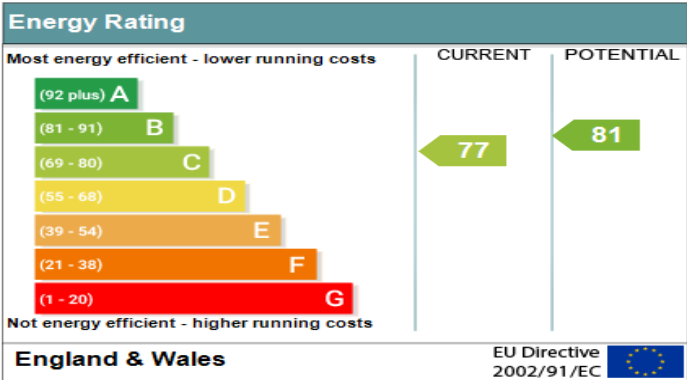

Furniture shown to illustrate possible room layouts and not included in sale. Designs vary according to plot and all details should be checked at the Sales office.
March 2024

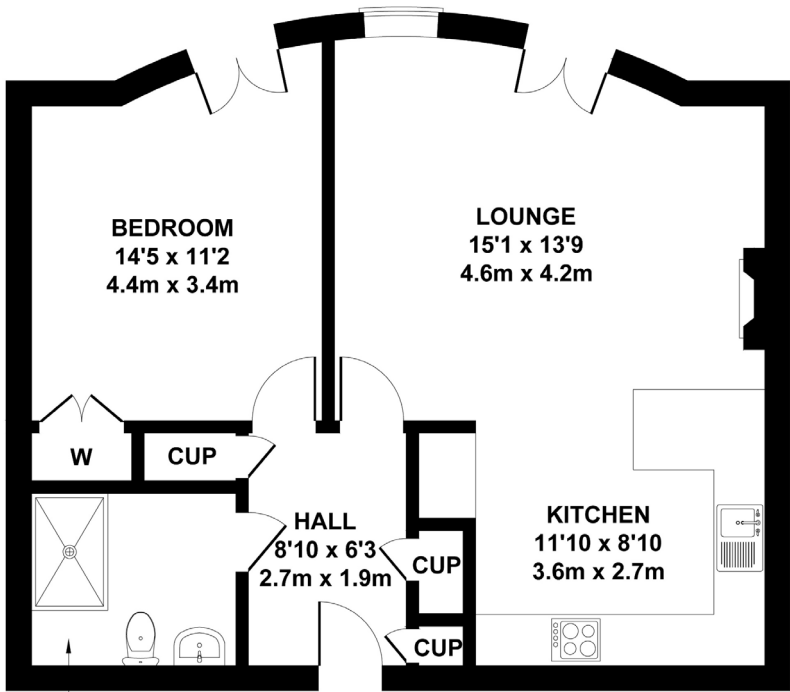

SHOWER ROOM
7'10 x 6'7
2.40m x 2.00m

APPROX. FLOOR
AREA 653 SQ.FT.
(60.7 SQ.M.)

Not to Scale. Produced by The Plan Portal 2024
For Illustrative Purposes Only.

